

# PCP<sup>®</sup>

Every Drop Counts

Made in

**COLOMBIA** 



SG-CER1027521



SA-2001424



CERTIFICADO BASC  
No. COLPEI00141-1-3



**PRODUCT  
CATALOG**

**#1** brand in **PVC & CPVC**  
*ball valves*  
in **Latin America**

Where to Find Us



Our export-driven model  
has allowed us to reach  
**13 countries.**

**PCP<sup>®</sup>**  
*Every Drop Counts*



# Ball valve and fitting solutions



# CONTENT

Ball Valve	5
3" Ball Valve with Long Handle	6
Heavy Duty Ball Valve	7
Heavy Duty Ball Valve with Long Handle	8
DZR Ultra Heavy Duty Ball Valve	9
Compact True Union Ball Valve	10
True Union Ball Valve	11
Irrigation Ball Valve	12
CPVC Ball Valve	13
Polypropylene Ball Valve	14
Hose Bibb	15
Socket Hose Bibb	16
Ultra Heavy Duty Hose Bibb	17
PE Toilet & Faucet Supply Line	18
Angle Valve Single And Double Outlet	19
Heavy Duty PVC Union	20
PVC Union	21
PVC Check Backwater Valve	22
PVC Van Stone Flange	23

# BALL VALVE

*This product does not corrode or wear out*

Ball valves must be operated either fully open or fully closed.  
They are not designed for flow regulation and should not be used with compressed air or gases.



Smooth and effortless quarter-turn operation for precise control.

Ideal for controlling water flow in common wet areas such as bathrooms, kitchens, patios, and decks.



Designed for reliable performance of up to 5,000 cycles.

## SCHEDULE:

SCH 40

## STANDARDS:

ASTM D2466

NSF Certified

## MAXIMUM WORKING PRESSURE:

150 PSI at 74°F (23 C°)

## DIMENSIONS:

All ball valves are available in Socket and Threaded (NPT) configurations.  
Dimensions are provided in inches:  
A = Width | B = Length | C = Height

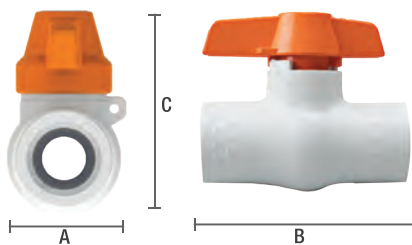

REF: Ball Valve

## PRODUCT VARIANTS:

SOCKET					THREADED				
Ref.	Nominal diameter	Dimensions (in)			Ref.	Nominal diameter	Dimensions (in)		
		A	B	C			A	B	C
3061	1/2"	1 5/32	2 3/4	2 5/16	3062	1/2"	1 5/32	2 3/4	2 5/16
3100	3/4"	1 9/16	3 5/32	2 3/4	3099	3/4"	1 9/16	3 5/32	2 3/4
3102	1"	2	3 1/2	3 5/32	3101	1"	2	3 1/2	3 5/32
3306	1 1/4"	2 5/16	4 5/32	3 3/4	3305	1 1/4"	2 5/16	4 5/32	3 3/4
3308	1 1/2"	2 11/16	4 3/4	4	3307	1 1/2"	2 11/16	4 3/4	4
3310	2"	3	5 1/8	4 3/4	3309	2"	3	5 1/8	4 3/4

NPT Thread  
A (Width) B (Length) C (Height)



# 3" BALL VALVE WITH LONG HANDLE

*Guarantees real 3" flow*



Ball valves must be operated either fully open or fully closed.  
They are not designed for flow regulation and should not be used with compressed air or gases.



Long handle for smooth and effortless turns.

Perfect complement for controlling outdoor pumping equipment.

Excellent for irrigation systems using chemical solutions

PVC ball resistant to corrosion and chemical agents



## SCHEDULE:

SCH 40

## STANDARDS:

(ASTM D2466)

## MAXIMUM WORKING PRESSURE:

150 PSI at 74°F (23 C°)

## DIMENSIONS:

All ball valves are available in Socket and Threaded (NPT) configurations.

Dimensions are provided in inches:  
A = Width | B = Length | C = Height

**Ideal** for  
**irrigation**  
*systems*

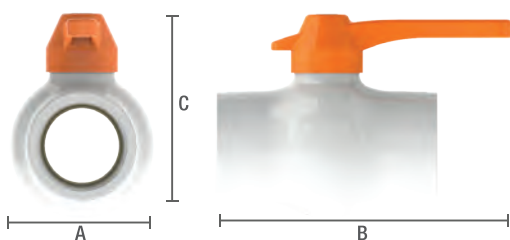

REF: Ball Valve 3"

## PRODUCT VARIANTS:

### SOCKET

Ref.	Nominal diameter	Dimensions (in)		
		A	B	C
3720	3"	5 1/2	8 1/2	7 13/16

### THREADED

Ref.	Nominal diameter	Dimensions (in)		
		A	B	C
3327	3"	5 1/2	8 1/2	7 13/16

**NPT Thread**  
A (Width) B (Length) C (Height)

# HEAVY DUTY BALL VALVE

*Avoids water contamination,  
does not corrode*



Ball valves must be operated either fully open or fully closed.  
They are not designed for flow regulation and should not be used with compressed air or gases.



Acreditado por ONAC

Engineered for reliable performance – tested for over 5,000 open-close cycles.



Withstands higher pressure than standard ball valves.

## SCHEDULE:

Socket end SCH 40 – body with SCH 80 wall thickness for extra durability

## STANDARDS:

(ASTM D2466) Socket  
(ASTM D2467) Threaded  
NSF - Certified

## MAXIMUM WORKING PRESSURE:

235 PSI at 74°F. In socket valves (23 C°)  
150 PSI at 74°F. In threaded valves (23 C°)

## DIMENSIONS:

All ball valves are available in Socket and Threaded (NPT) configurations.  
Dimensions are provided in inches:  
A = Width | B = Length | C = Height

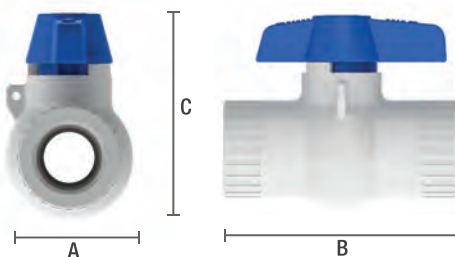

REF: Ball Valve 3/4"

The  
**preferred**  
choice by *experts*

## PRODUCT VARIANTS:

### SOCKET

Ref.	Nominal diameter	Dimensions (in)		
		A	B	C
3011	1/2"	1 5/32	3 5/32	2 5/16
3039	3/4"	1 3/4	3 1/2	3
3041	1"	2	4	3 5/32
3084	1 1/4"	2 1/2	4 3/16	3 3/4
3070	1 1/2"	2 3/4	4 3/4	4 3/16
3074	2"	3 5/16	5 1/8	4 3/4

### THREADED

Ref.	Nominal diameter	Dimensions (in)		
		A	B	C
3012	1/2"	1 3/8	3 5/32	2 5/16
3040	3/4"	1 3/4	3 1/2	2 3/4
3042	1"	2 1/16	4	3 5/32
3085	1 1/4"	2 1/2	4 3/16	3 3/4
3071	1 1/2"	2 3/4	4 3/4	4 5/32
3075	2"	3 1/4	5 1/8	4 3/4

NPT Thread

A (Width) B (Length) C (Height)

# HEAVY DUTY BALL VALVE WITH LONG HANDLE

*Ergonomic long handle for better grip and smoother operation*



Ball valves must be operated either fully open or fully closed.  
They are not designed for flow regulation and should not be used with compressed air or gases.



Acreditado por ONAC

Designed for frequent operation and long service life.

## SCHEDULE:

Socket end SCH 40 – body with SCH 80 wall thickness for extra durability

## STANDARDS:

(ASTM D2466) Socket  
(ASTM D2467) Threaded

## MAXIMUM WORKING PRESSURE:

235 PSI at 74°F. In socket valves (23 C°)  
150 PSI at 74°F. In threaded valves (23 C°)

## DIMENSIONS:

All ball valves are available in Socket and Threaded (NPT) configurations.  
Dimensions are provided in inches:  
A = Width | B = Length | C = Height

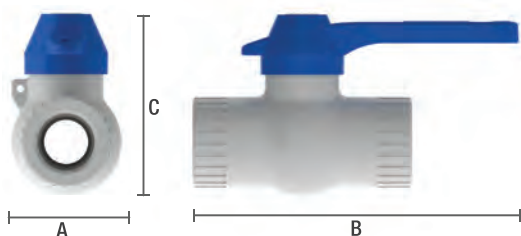

REF: Ball Valve 3/4"

Body and handle in hydraulic PVC.

Compact, reinforced body provides superior pressure resistance.

**Easy**  
to *use*

## PRODUCT VARIANTS:

### SOCKET

Ref.	Nominal diameter	Dimensions (in)		
		A	B	C
3168	1/2"	1 7/16	4 5/8	2 5/16
3170	3/4"	1 13/16	5 1/2	3
3372	1"	2 1/8	5 3/4	3 5/32
3374	1 1/4"	2 1/2	6 9/16	3 9/16
3376	1 1/2"	2 13/16	6 3/4	4 5/8
3302	2"	3 1/4	7 1/2	4 3/4

### THREADED

Ref.	Nominal diameter	Dimensions (in)		
		A	B	C
3167	1/2"	1 7/16	4 5/8	2 1/3
3169	3/4"	1 13/16	5 1/2	3
3371	1"	2 1/8	5 3/4	3 1/6
3373	1 1/4"	2 1/2	6 9/16	3 5/8
3375	1 1/2"	2 13/16	6 3/4	4 5/8
3301	2"	3 1/4	7 1/2	4 3/4

NPT Thread

A (Width) B (Length) C (Height)



# DZR ULTRA HEAVY DUTY BALL VALVE

*Corrosion-resistant alternative to metallic valves for cold water applications*

Engineered for maximum torque and stress resistance in water piping systems.

Ideal for infrastructure, industrial, and residential water piping systems.

## SCHEDULE:

SCH 80

## STANDARDS:

(ASTM D2467)

## MAXIMUM WORKING PRESSURE:

235 PSI at 74°F. (23 C°)

## DIMENSIONS:

All ball valves are available in Socket and Threaded (NPT) configurations.

Dimensions are provided in inches:  
A = Width | B = Length | C = Height

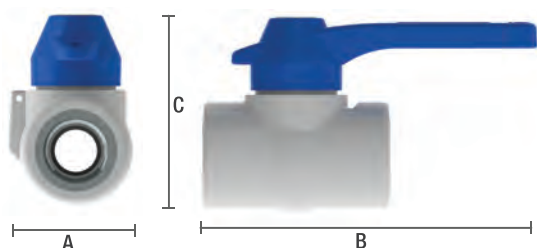

REF: Ball Valve 1/2" x 1/2" DZR instert



Ball valves must be operated either fully open or fully closed.  
They are not designed for flow regulation and should not be used with compressed air or gases.



CO21.02089

Acreditado por ONAC



Features a corrosion-resistant DZR brass insert for enhanced durability and safe water quality.

For  
**demanding**  
*tasks*

## PRODUCT VARIANTS:

### DZR BRASS INSERT

Ref.	Nominal diameter	Dimensions (in)		
		A	B	C
3311	1/2" x 1/2"	1 9/16	2 5/16	2 3/8
3314	3/4" x 3/4"	1 3/4	2 7/8	2 3/4

**NPT Thread**

A (Width) B (Length) C (Height)

# COMPACT TRUE UNION BALL VALVE



Ball valves must be operated either fully open or fully closed.  
They are not designed for flow regulation and should not be used with compressed air or gases.



*Engineered for durability and precision, this valve delivers reliable shut-off performance in residential plumbing applications.*

True Union Design –  
Allows easy installation  
and removal without  
tools



Quarter-Turn Operation  
– Fast and secure  
shut-off with minimal  
effort

Tight Precision Fit –  
Ensures leak-free  
connections

## STANDARDS:

(ASTM D2466) In socket valves  
(ASTM D2467) In threaded valves

## MAXIMUM WORKING PRESSURE:

150 PSI at 74°F. In threaded valves (23 C°)

## DIMENSIONS:

All ball valves are available in Socket and Threaded (NPT) configurations.  
Dimensions are provided in inches:  
A = Width | B = Length | C = Height

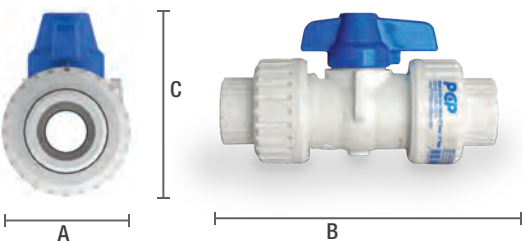

REF: Compact True Union Ball Valve 1/2"

Tool Free **Assembly**  
*Simplifies* maintenance  
and **installation**

## PRODUCT VARIANTS:

### SOCKET

Ref.	Nominal diameter	Dimensions (in)		
		A	B	C
3027	1/2" heavy duty	1 13/16	4 3/4	2 5/8
3294	3/4"	2	4 1/2	3

### THREADED

Ref.	Nominal diameter	Dimensions (in)		
		A	B	C
3029	1/2" heavy duty	1 13/16	1 13/16	2 5/8
3026	1/2"	1 3/4	4 1/4	2 1/2
3293	3/4"	2	4 3/4	3

NPT Thread

A (Width) B (Length) C (Height)

# TRUE UNION BALL VALVE

Designed for easy disassembly, cleaning, and routine maintenance

Designed with anchoring features for secure installation in control boxes

**SCHEDULE:**  
 Ball Valves Socket SCH 40  
 Ball Valves Threaded SCH 80

**STANDARDS:**  
 (ASTM D2467)

**MAXIMUM WORKING PRESSURE:**  
 235 PSI at 74°F. In socket valves (23 C°)  
 150 PSI at 74°F. In threaded valves (23 C°)

**DIMENSIONS:**  
 All ball valves are available in Socket and Threaded (NPT) configurations.  
 Dimensions are provided in inches:  
 A = Width | B = Length | C = Height

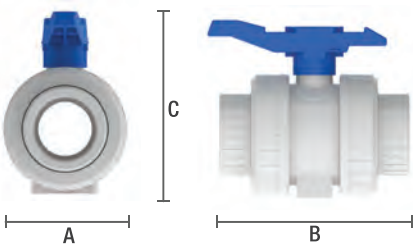

REF: Double Union Ball Valve 2"

Ball valves must be operated either fully open or fully closed. They are not designed for flow regulation and should not be used with compressed air or gases.



True union design allows quick disassembly for easy cleaning and maintenance.

100%  
 fully serviceable  
 for maintenance

## PRODUCT VARIANTS: SOCKET

Ref.	Nominal diameter	Dimensions (in)		
		A	B	C
3187	2" one union	4 5/16	6 5/8	6 5/16
3188	2" two union	4 5/16	7 3/32	6 5/16

## THREADED

Ref.	Nominal diameter	Dimensions (in)		
		A	B	C
3184	2" one union	4 5/16	6 5/16	6 5/16
3186	2" two union	4 5/16	7 3/32	6 5/16

NPT Thread  
 A (Width) B (Length) C (Height)



# IRRIGATION BALL VALVE

*Ideal for Irrigation Systems and Chemical Applications*



Ball valves must be operated either fully open or fully closed.  
They are not designed for flow regulation and should not be used with compressed air or gases.



Enhanced UV protection for extended outdoor durability.

PVC ball highly resistant to chemicals commonly used in agricultural and irrigation applications.

## SCHEDULE:

Ball Valves Socket SCH 40  
Ball Valves Threaded SCH 80

## STANDARDS:

(ASTM D2466) Socket  
(ASTM D2467) Threaded

## MAXIMUM WORKING PRESSURE:

235 PSI at 74°F. In socket valves (23 C°)  
150 PSI at 74°F. In threaded valves (23 C°)

## DIMENSIONS:

All ball valves are available in Socket and Threaded (NPT) configurations.  
Dimensions are provided in inches:  
A = Width | B = Length | C = Height

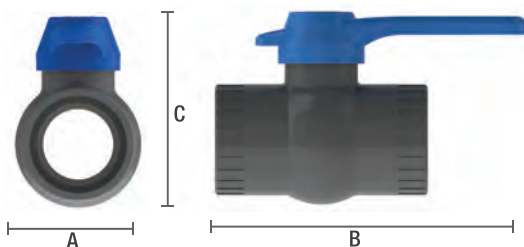

REF: Ball Valve for irrigation 2"

Ideal for water distribution systems including aquaculture, fish farming, and similar applications.

Ideal for  
**Agricultural**  
and **irrigation**  
*systems*

## PRODUCT VARIANTS:

### SOCKET

Ref.	Nominal diameter	Dimensions (in)		
		A	B	C
3709	1 1/2"	2 13/16	6 3/4	4 5/32
3711	2"	4 3/4	7 1/2	3 5/16

### THREADED

Ref.	Nominal diameter	Dimensions (in)		
		A	B	C
3710	1 1/2"	2 13/16	3/4	4 5/32
3712	2"	4 3/4	7 1/2	3 5/16

*NPT Thread*

A (Width) B (Length) C (Height)

# CPVC BALL VALVE

*Reliable solution for high-temperature water systems.*

Suitable for **hot** and **cold water** applications-rated up to 180°F (82°C).  **180°F.\***



Ball valves must be operated either fully open or fully closed. They are not designed for flow regulation and should not be used with compressed air or gases.



Exclusive manufacturers of high-quality CPVC valves in Latin America.

## SCHEDULE:

SCH 40

## STANDARDS:

CTS (Copper tube size)

(ASTM 2846)

NSF Certified

## MAXIMUM WORKING PRESSURE:

150 PSI at 74° F (23 C°)

100 PSI at 180°F (82 C°)

\*According to ASTM D2846 standard, pressures and conditions of use apply according to water temperature. The pressure-temperature relationship is inversely proportional.

## DIMENSIONS:

Dimensions are provided in inches:  
A = Width | B = Length | C = Height

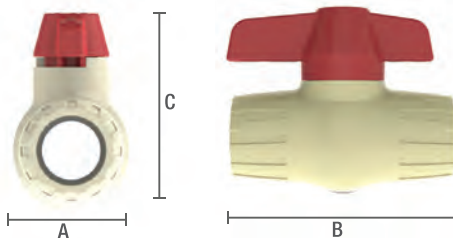

REF: CPVC Ball Valve for irrigation 1/2"



Ideal for controlling hot water flow in tankless and pressurized systems.



Secure socket connection ensures leak-free performance.

**Compact** *design*  
for easy **installation**  
in tight spaces

## PRODUCT VARIANTS: SOCKET

Ref.	Nominal diameter	Dimensions (in)		
		A	B	C
3748	1/2"	1 5/32	2 1/2	2
3749	3/4"	1 9/16	3 5/16	2 3/4
3747	1"	2	3 3/4	3 1/6

A (Width) B (Length) C (Height)

# POLYPROPYLENE BALL VALVE

*Engineered for Reliable Hot Water Piping Systems*

Suitable for **hot** and **cold water** systems – rated up to 160°F (71°C). **160°F.\***



Ball valves must be operated either fully open or fully closed. They are not designed for flow regulation and should not be used with compressed air or gases.



Manufactured from polypropylene for extended lifespan in both hot and cold water applications.

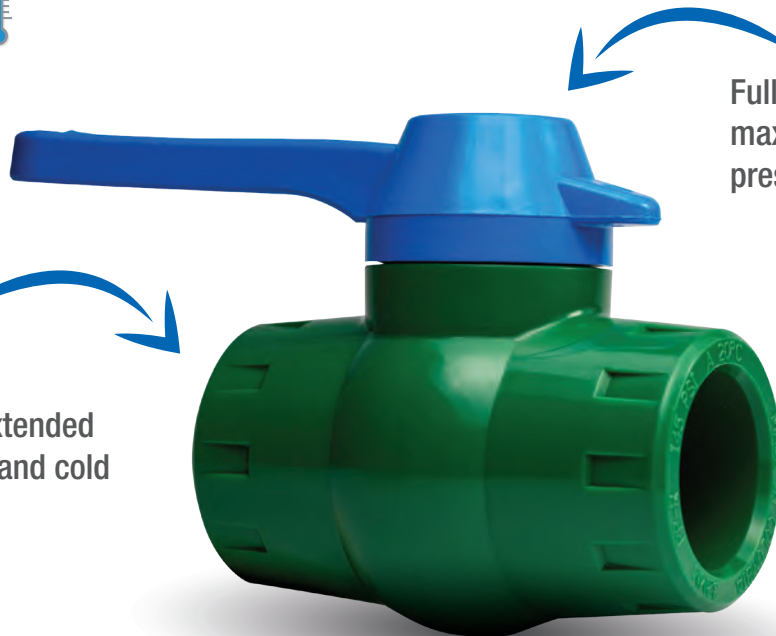

Full-bore design delivers maximum flow without pressure loss.

Thermofusion weld ensures leak-free and secure installation.

## STANDARDS:

CTS (Copper tube size)

## MAXIMUM WORKING PRESSURE:

150 PSI at 74° F (23 C°)

100 PSI at 160°F (71 C°)

\*According to ASTM D2846 standard, pressures and conditions of use apply according to water temperature. The pressure-temperature relationship is inversely proportional.

## DIMENSIONS:

Dimensions are provided in inches:  
A = Width | B = Length | C = Height

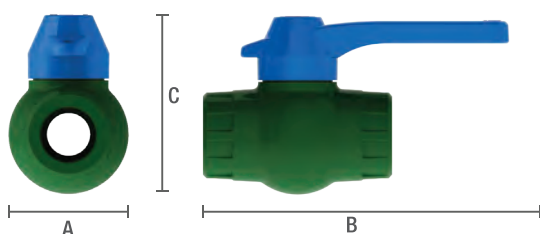

REF: PP Ball Valve 25mm

**Robust, reinforced** body  
offers high *mechanical* strength and durability

## PRODUCT VARIANTS: THERMOFUSION

Ref.	Nominal diameter	Dimensions (in)		
		A	B	C
3123	20 mm	1 9/16	4 5/32	2 9/16
3125	25 mm	2	5	3 5/32
3122	32 mm	2 3/16	5 3/8	3 3/8

A (Width) B (Length) C (Height)



# HOSE BIBB

Shuts off in both directions



Compatible with optional reducer and water-saving jet nozzle.

Nylon insert made of high-performance engineering resin - resists impact and torsion.



Unique dual-direction closure — right- and left-hand shut-off

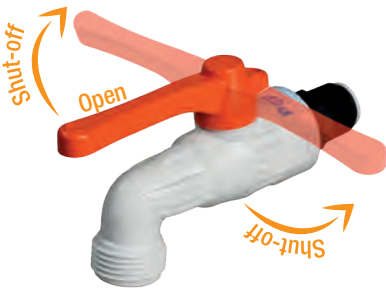

**SCHEDULE:**  
SCH 40

**STANDARDS:**  
(ASTM D2466)

**MAXIMUM WORKING PRESSURE:**  
150 PSI at 74°F. (23 C°)

**DIMENSIONS:**

Dimensions are provided in inches:  
A = Width | B = Length | C = Height

Unlike any other

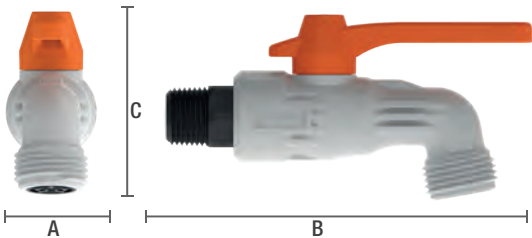

REF: Hose Bibb

## PRODUCT VARIANTS: MALE

Ref.	Nominal diameter	Dimensions (in)		
		A	B	C
1022	1/2"	1 5/16	5 1/8	2 9/16

A (Width) B (Length) C (Height)

# SOCKET HOSE BIBB



Ideal for installations at internal and external points

Tool-free installation

First socket hose Bibb in the market.

Unique dual-direction closure — right- and left-hand shut-off



**SCHEDULE:**  
SCH 40

**STANDARDS:**  
(ASTM D2466)

**MAXIMUM WORKING PRESSURE:**  
150 PSI at 74°F. (23 C°)

**DIMENSIONS:**

Dimensions are provided in inches:  
A = Width | B = Length | C = Height

No adapter  
needed

## PRODUCT VARIANTS: SOCKET

Ref.	Nominal diameter	Dimensions (in)		
		A	B	C
2015	1/2"	1 5/16	3 2/3	2 7/8

A (Width) B (Length) C (Height)

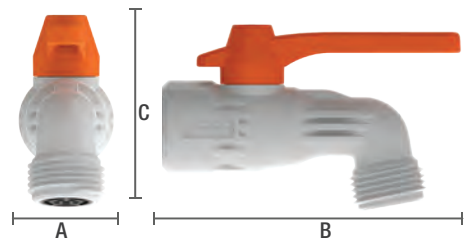

REF: Hose Bibb

# ULTRA HEAVY DUTY HOSE BIBB

*Shuts off in both directions*



Acreditado por ONAC

Unique dual-direction  
Ideal accessory for  
outdoor water point  
installations or in higher  
pressure points

Features a  
corrosion-resistant  
DZR brass insert for  
enhanced durability  
and safe water quality.



Unique  
dual-direction  
closure — right- and  
left-hand shut-off

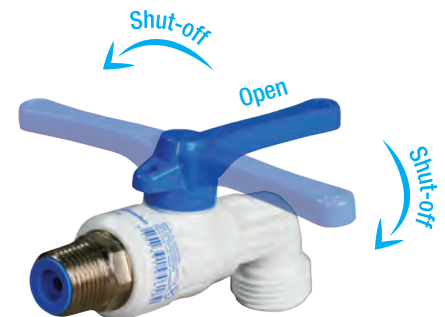

## SCHEDULE:

SCH 40

## STANDARDS:

(ASTM D2466)

## MAXIMUM WORKING PRESSURE:

150 PSI at 74°F. (23 C°)

## DIMENSIONS:

Dimensions are provided in inches:  
A = Width | B = Length | C = Height

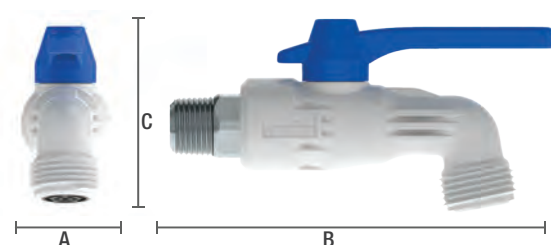

REF: Ultra Heavy Duty Hose Bibb

**Durable**  
for *rough* conditions

## PRODUCT VARIANTS:

### MALE

Ref.	Nominal diameter	Dimensions (in)		
		A	B	C
1024	1/2"	1 5/16	3 11/16	2 7/8

### FEMALE

Ref.	Nominal diameter	Dimensions (in)		
		A	B	C
1021	1/2"	3,3	12	7,3

A (Width) B (Length) C (Height)



# PE TOILET & FAUCET SUPPLY LINE

*Exclusive 3-wing nut design for quick  
and easy installation*



Suitable for **hot** and  
**cold** water  
applications-rated up  
to 180°F (82°C).

**180°F.**

Suitable for  
hot water

Prevents solid  
residue buildup.

High Quality Polyethylene  
makes it flexible and  
durable even in tight  
spaces



**Flexible**  
and *reliable*

## MAXIMUM WORKING PRESSURE:

150 PSI at 74°F. (23 C°)

## DIMENSIONS:



## PRODUCT VARIANTS:

### Ref.

2005 Supply Line for faucet 16in
2008 Supply Line for faucet 24in
2004 Supply Line for toilet 16in
2007 Supply Line for toilet 24in

**1/2" NPS x 1/2" NPS FAUCET**  
**1/2" NPS x 7/8" NPS TOILET**

# ANGLE VALVE SINGLE AND DOUBLE OUTLET

*Easy operation and installation  
Ideal for controlling water flow in  
residential applications*



Suitable for **hot** and **cold** water  
applications-rated up  
to 180°F (82°C).

**180°F.**

Allows isolation of water  
flow anywhere in the  
house without shutting off  
the main line.

Angle valve,  
ideal for water  
check point

Suitable for hot and  
cold water

Protective  
nipple shield

Made of high-resistance  
POM, known for it's  
durability towards hot water  
Quarter-turn mechanism for  
fast operation 1/2" inlet and  
outlet threads

**No need to**  
shut off the *water line*  
in the whole house.

**MAXIMUM WORKING PRESSURE:**  
150 PSI at 74°F. (23 C°)

## PRODUCT VARIANTS:

Ref.

2024 Single Angle Valve 1/2" x 1/2"

2013 Dual Angle Valve 1/2" x 1/2"

# HEAVY DUTY PVC UNION

*Designed to Prevent Pressure Loss*



Acreditado por ONAC

Optimized O-ring cavity ensures reliable, leak-proof sealing.

Quick and easy installation-no tools required.



Available in socket and threaded configurations, from 1/2" up to 4".

## SCHEDULE:

Union Socket SCH 40  
Union Threaded SCH 80

## STANDARDS:

(ASTM D2466) Socket  
(ASTM D2467) Threaded  
NSF Certified

## MAXIMUM WORKING PRESSURE:

235 PSI at 74°F. In socket unions (23 C°)  
150 PSI at 74°F. In threaded unions (23 C°)

## DIMENSIONS:

All ball valves are available in Socket and Threaded (NPT) configurations.  
Dimensions are provided in inches:  
A = Width | B = Length | C = Height

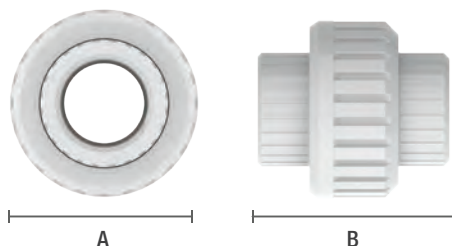

REF: Union Socket 1/2"

## PRODUCT VARIANTS:

### SOCKET

Ref.	Nominal diameter	Dimensions (in) A	Dimensions (in) B
3001	1/2"	5/8	2
3018	3/4"	2 3/32	2 3/32
3003	1"	2 1/2	2 7/8
3005	1 1/4"	3	3 5/16
3007	1 1/2"	3 1/4	3 1/2
3009	2"	3 13/16	3 1/2
3013	3"	5 1/2	5 3/16
3015	4"	6 9/16	5 5/8

### THREADED

Ref.	Nominal diameter	Dimensions (in) A	Dimensions (in) B
3002	1/2"	1 13/16	2
3019	3/4"	2 3/32	2 1/8
3004	1"	1 13/16	2
3006	1 1/4"	3	3 5/16
3008	1 1/2"	3 5/16	3 1/2
3010	2"	3 13/16	3 1/2
3014	3"	5 3/16	5 3/16
3016	4"	6 1/2	5 5/8

NPT Thread  
A (Width) B (Length)



# PVC UNION

*Quick and Easy Installation*



Acreditado por ONAC

Designed for fast,  
tool-free assembly.

Optimized O-ring cavity  
guarantees reliable,  
leak-proof sealing.

Ensures full flow-no  
pressure loss or flow  
reduction.



## SCHEDULE:

SCH 40

## STANDARDS:

(ASTM D2466)

## MAXIMUM WORKING PRESSURE:

150 PSI at 74°F (23 C°)

## DIMENSIONS:

Dimensions are provided in inches:  
A = Width | B = Length | C = Height

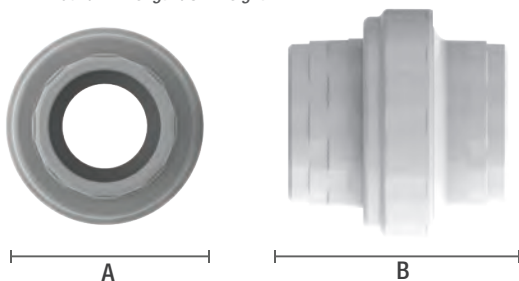

REF: Union Socket 1/2"

**Compact design**  
ideal for **instalations**  
in tight or limited spaces.

## PRODUCT VARIANTS: SOCKET

Ref.	Nominal diameter	Dimensions (in)	
		A	B
3189	1/2"	1 4/5	1 3/4
3185	3/4"	1 7/8	2 1/16

A (Width) B (Length)

# PVC CHECK BACKWATER VALVE

*Prevents backflow, waste water and rodent entry from street sewer lines*

Built-in spirit level ensures accurate installation

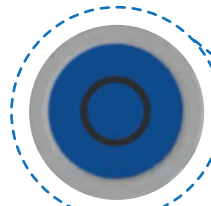
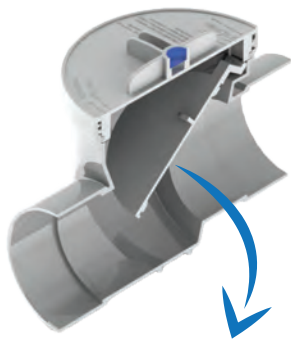

TPV O-ring for a secure and long-lasting seal



Applies to ref. 3148 and 3377

Resolución 501  
01 Agosto 2017

**BUREAU VERITAS**  
Certification

CO21.02089



Acreditado por ONAC

Prevents entry of



Rodents



Insects



Flooding

Removable lid for easy inspection and maintenance

Support base to ensure stability

**Works**  
by *gravity*  
not by pressure

## PRODUCT VARIANTS: CHECK VALVE

Ref.	Nominal diameter	Dimensions (in)		
		A	B	C
3148	4"	7 5/16	10 5/8	8 1/8
3166	110mm	7 5/16	10 5/8	8 1/8
3377	6"	10 5/16	15 1/2	10 1/8
3383	160mm	10 5/16	15 1/2	10 3/16

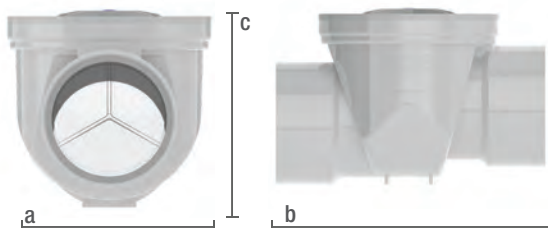

REF:Swing Check Valve 4"

A (Width) B (Length) C (Height)

# PVC VAN STONE FLANGE

## Ideal for Butterfly Valve Assemblies

Designed specifically for installations involving pumps, providing superior vibration resistance.

Van Stone design allows independent bolt-hole alignment for easy installation and adjustments.

### SCHEDULE:

SCH 80

### STANDARDS:

(ASTM D2466) Socket  
(ASTM D2467) Threaded

### MAXIMUM WORKING PRESSURE:

235 PSI at 74°F (23 C°)

### DIMENSIONS:

All ball valves are available in Socket and Threaded (NPT) configurations.  
Dimensions are provided in inches:  
A = Width | B = Length | C = Height

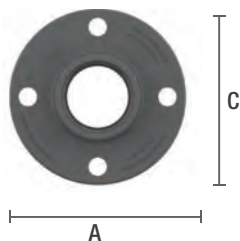

REF: PVC flange van stone 2"



Resolución 501  
01 Agosto 2017

**BUREAU VERITAS**  
Certification

CO21.02089



Acreditado por ONAC

Nominal diameter	Screw specification Diameter x Length	Number of screws
2"	5/8" x 2 1/2"	4
3"	5/8" x 3"	4
4"	5/8" x 3"	8
6"	3/4" x 3 1/2"	8
8"	3/4" x 8"	8

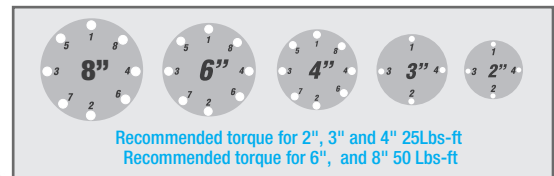

Manufactured entirely from high-quality PVC for corrosion resistance and durability.

Robust bolt connection system ensures secure attachment and reliable performance.

*High*  
**resistance**  
disc

## PRODUCT VARIANTS: SOCKET

Ref.	Nominal diameter	Dimensions (in)	
		A	C
3106	2"	5 7/8	5 7/8
3087	3"	7 1/2	7 1/2
3089	4"	9 1/16	9 1/16
3091	6"	10 3/4	10 3/4
3384	8"	13 3/8	13 3/8

## THREADED

Ref.	Nominal diameter	Dimensions (in)	
		A	C
3105	2"	5 7/8	5 7/8
3088	3"	7 1/2	7 1/2
3090	4"	9 1/16	9 1/16
3107	6"	10 3/4	10 3/4
3385	8"	13 3/8	13 3/8

NPT Thread

A (Width) C (Height)





[www.PCPplasticos.com](http://www.PCPplasticos.com)

## PCP demonstrates its environmental commitment through action

"Caring for water is caring for humanity. By choosing PCP products, hardware stores and builders are making a conscious decision—for the planet and for future generations. Now, more than ever, **every drop counts.**"

**Luis Arango, CEO.**



More than 1,500  
Solar Panels



91,600 ft<sup>2</sup> Manufacturing  
Facility



Domestic Wastewater  
Treatment Plant (DWWTP)



5 Dedicated Logistics  
Docks



Rainwater Collection  
System-700 m<sup>3</sup> capacity



Km 3 Vía Cerritos La Virginia  
Costado Izquierdo  
[servicioalcliente@pcpplasticos.com](mailto:servicioalcliente@pcpplasticos.com)  
Pereira, Colombia



Prolongación José María Pino Suarez 1039  
bodega 6, Colonia El Vigía, CP 45140 en Zapopan.  
[pcpmexico@pcpplasticos.com](mailto:pcpmexico@pcpplasticos.com)  
Jalisco, México



Carretera Panamericana sur km. 29.5  
zona industrial Lurín (mega centro)  
[ventasperu@pcpplasticos.com](mailto:ventasperu@pcpplasticos.com)  
Lima, Perú